



**MyCARE**  
Humanitarian Care Malaysia

# INTERIOR DESIGN WORK

PROPOSED INTERIOR RENOVATION WORKS AT LOT 7 AND 9, JALAN DAGANG SB 4/1, TAMAN SUNGAI BESI INDAH, SERI KEMBANGAN, SELANGOR FOR HUMANITARIAN CARE MALAYSIA (MYCARE)



*FIRADAUS  
KHAZIS  
ARCHITECT*

# LEVEL GROUND PLAN



PROPOSED INTERIOR RENOVATION WORKS AT LOT 7 AND 9, JALAN DAGANG SB 4/1, TAMAN SUNGAI BESI INDAH, SERI KEMBANGAN, SELANGOR FOR HUMANITARIAN CARE MALAYSIA (MYCARE)

# LEVEL 1 PLAN

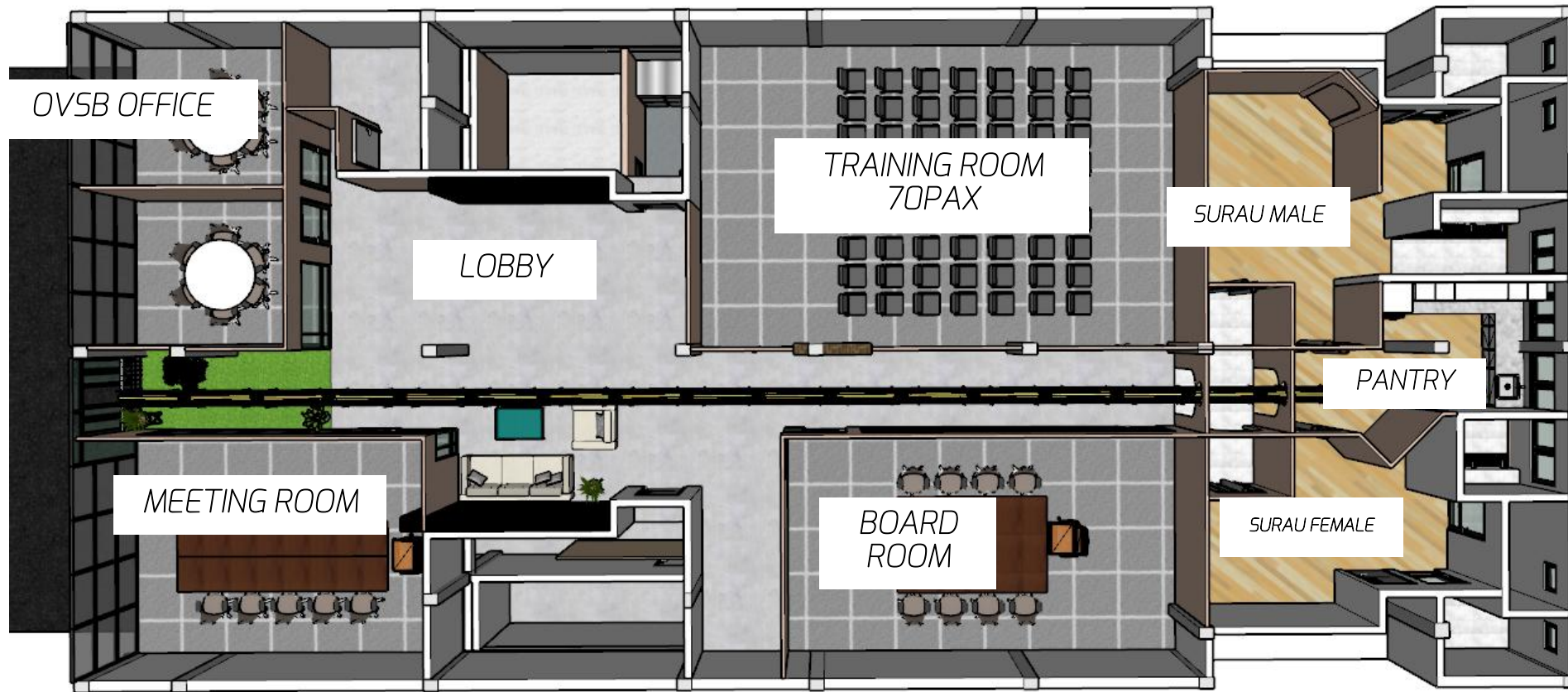

PROPOSED INTERIOR RENOVATION WORKS AT LOT 7 AND 9, JALAN DAGANG SB 4/1, TAMAN SUNGAI BESI INDAH, SERI KEMBANGAN, SELANGOR FOR HUMANITARIAN CARE MALAYSIA (MYCARE)

# LEVEL 2 PLAN

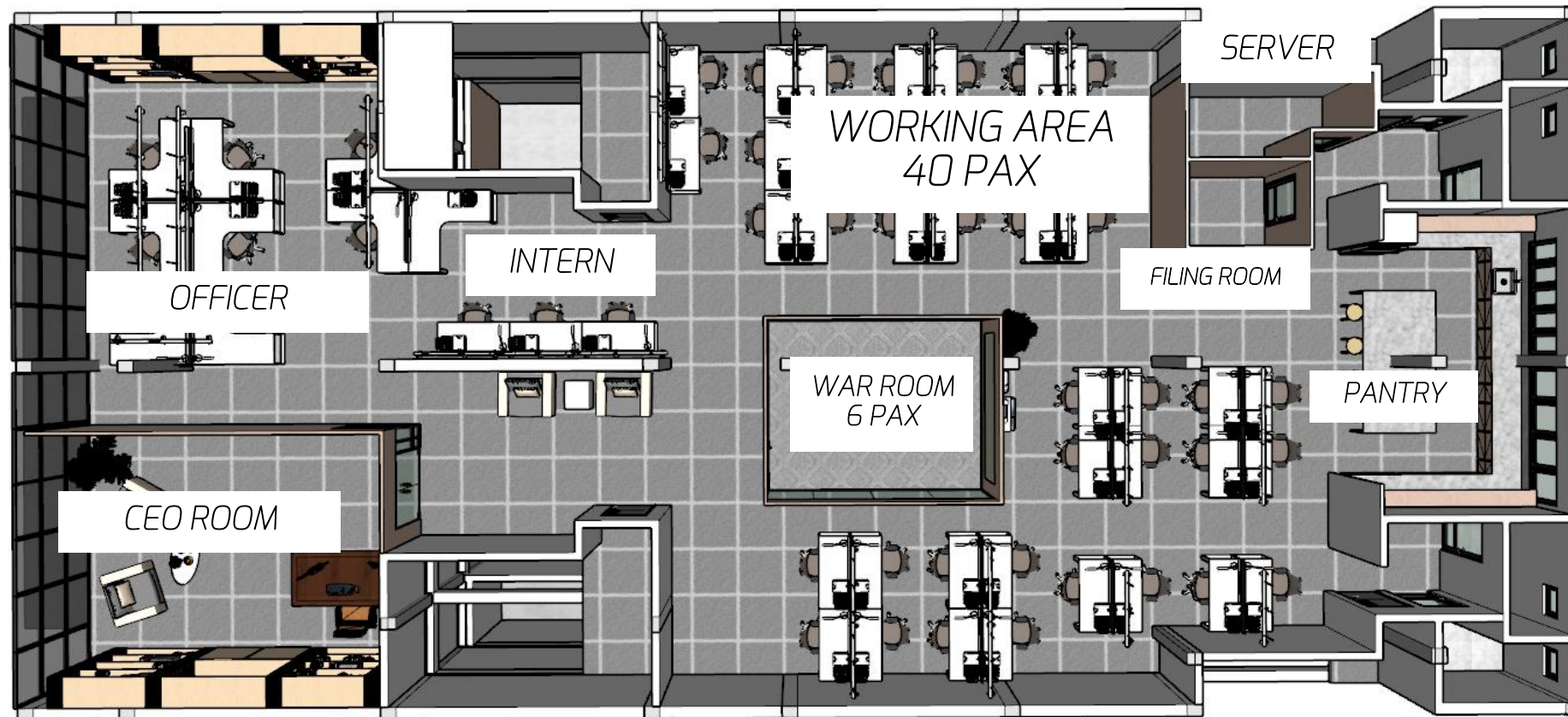

PROPOSED INTERIOR RENOVATION WORKS AT LOT 7 AND 9, JALAN DAGANG SB 4/1, TAMAN SUNGAI BESI INDAH, SERI KEMBANGAN, SELANGOR FOR HUMANITARIAN CARE MALAYSIA (MYCARE)

# LEVEL 3 PLAN



# GROUND FLOOR



PROPOSED INTERIOR RENOVATION WORKS AT LOT 7 AND 9, JALAN DAGANG SB 4/1, TAMAN SUNGAI BESI INDAH, SERI KEMBANGAN, SELANGOR FOR HUMANITARIAN CARE MALAYSIA (MYCARE)



**FIRADAUS  
KHAZIS  
ARCHITECT**

GROUND FLOOR



PROPOSED INTERIOR RENOVATION WORKS AT LOT 7 AND 9, JALAN DAGANG SB 4/1, TAMAN SUNGAI BESI INDAH, SERI KEMBANGAN, SELANGOR FOR HUMANITARIAN CARE MALAYSIA (MYCARE)



FIRADAUS  
KHAZIS  
ARCHITECT

# GROUND FLOOR



PROPOSED INTERIOR RENOVATION WORKS AT LOT 7 AND 9, JALAN DAGANG SB 4/1, TAMAN SUNGAI BESI INDAH, SERI KEMBANGAN, SELANGOR FOR HUMANITARIAN CARE MALAYSIA (MYCARE)

GROUND FLOOR



PROPOSED INTERIOR RENOVATION WORKS AT LOT 7 AND 9, JALAN DAGANG SB 4/1, TAMAN SUNGAI BESI INDAH, SERI KEMBANGAN, SELANGOR FOR HUMANITARIAN CARE MALAYSIA (MYCARE)

# GROUND: WAREHOUSE

MAXIMIZE STORAGE WITH  
COMPACT STORAGE SYSTEM  
MAXIMIZE LOADING AREA AND  
WORKING AREA



## GROUND: WAREHOUSE



MAXIMIZE STORAGE WITH  
COMPACT STORAGE  
SYSTEM  
MAXIMIZE LOADING AREA  
AND WORKING AREA



PROPOSED INTERIOR RENOVATION WORKS AT LOT 7 AND 9, JALAN DAGANG SB 4/1, TAMAN SUNGAI BESI INDAH, SERI KEMBANGAN, SELANGOR FOR HUMANITARIAN CARE MALAYSIA (MYCARE)

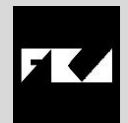

FIRADAUS  
KHAZIS  
ARCHITECT

GROUND: WAREHOUSE



PROPOSED INTERIOR RENOVATION WORKS AT LOT 7 AND 9, JALAN DAGANG SB 4/1, TAMAN SUNGAI BESI INDAH, SERI KEMBANGAN, SELANGOR FOR HUMANITARIAN CARE MALAYSIA (MYCARE)



FIRDAUS  
KHAZIS  
ARCHITECT

Lvl 1: COMMON AREA



PROPOSED INTERIOR RENOVATION WORKS AT LOT 7 AND 9, JALAN DAGANG SB 4/1, TAMAN SUNGAI BESI INDAH, SERI KEMBANGAN, SELANGOR FOR HUMANITARIAN CARE MALAYSIA (MYCARE)

# TRAINING ROOM



PROPOSED INTERIOR RENOVATION WORKS AT LOT 7 AND 9, JALAN DAGANG SB 4/1, TAMAN SUNGAI BESI INDAH, SERI KEMBANGAN, SELANGOR FOR HUMANITARIAN CARE MALAYSIA (MYCARE)

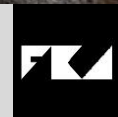

**FIRDAUS  
KHAZIS  
ARCHITECT**

# MEETING ROOM



PROPOSED INTERIOR RENOVATION WORKS AT LOT 7 AND 9, JALAN DAGANG SB 4/1, TAMAN SUNGAI BESI INDAH, SERI KEMBANGAN, SELANGOR FOR HUMANITARIAN CARE MALAYSIA (MYCARE)



FIRADAUS  
KHAZIS  
ARCHITECT

## SURAU ENTRANCE



PROPOSED INTERIOR RENOVATION WORKS AT LOT 7 AND 9, JALAN DAGANG SB 4/1, TAMAN SUNGAI BESI INDAH, SERI KEMBANGAN, SELANGOR FOR HUMANITARIAN CARE MALAYSIA (MYCARE)

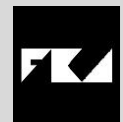

**FIRADAUS  
KHAZIS  
ARCHITECT**

Surau



PROPOSED INTERIOR RENOVATION WORKS AT LOT 7 AND 9, JALAN DAGANG SB 4/1, TAMAN SUNGAI BESI INDAH, SERI KEMBANGAN, SELANGOR FOR HUMANITARIAN CARE MALAYSIA (MYCARE)

## DETAIL

*recycle brick collected from  
hacked party wall is used as part  
of decoration*

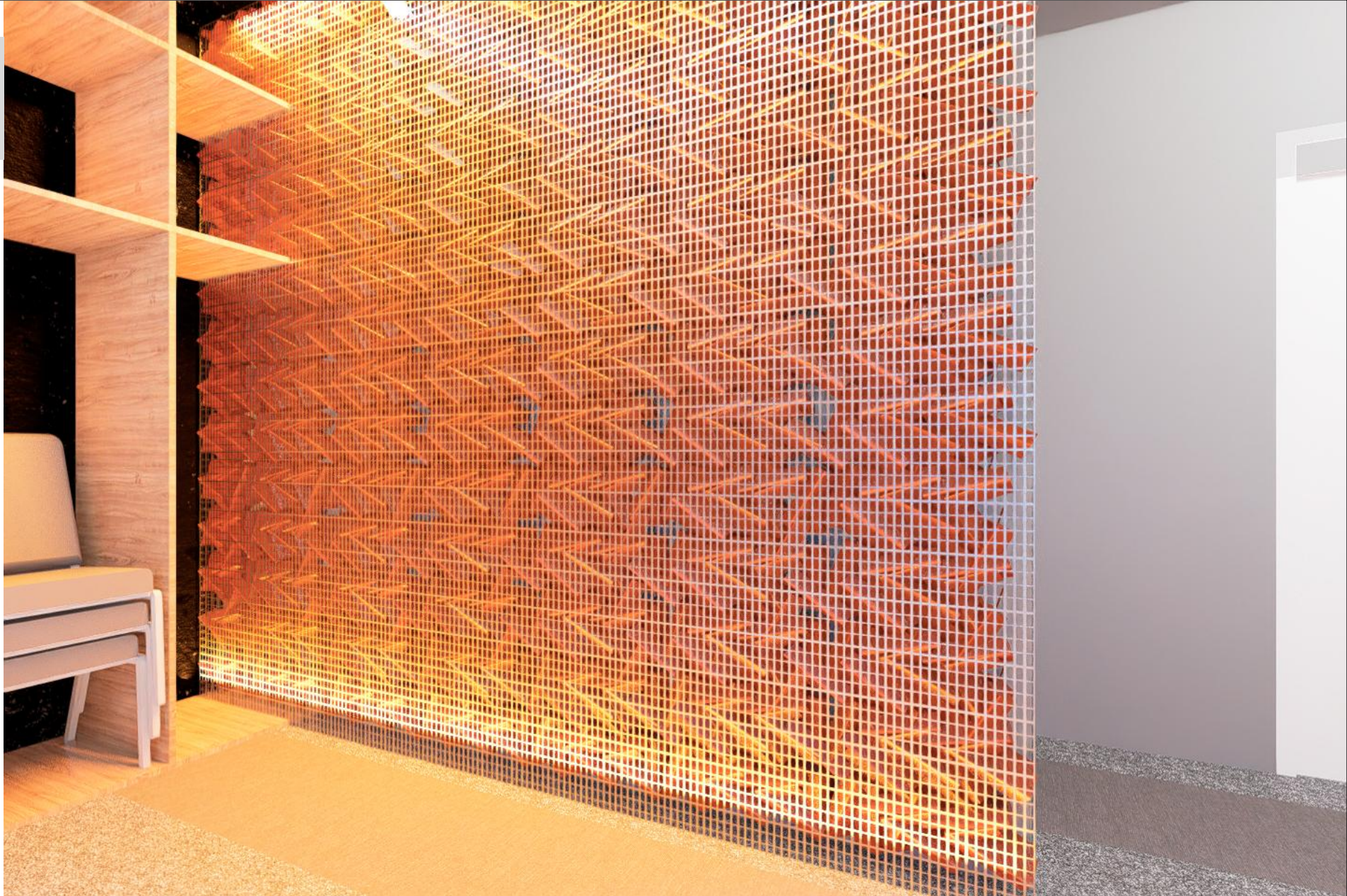

PROPOSED INTERIOR RENOVATION WORKS AT LOT 7 AND 9, JALAN DAGANG SB 4/1, TAMAN SUNGAI BESI INDAH,  
SERI KEMBANGAN, SELANGOR FOR HUMANITARIAN CARE MALAYSIA (MYCARE)



**FIRADAUS  
KHAZIS  
ARCHITECT**

LVL 1: CORRIDOR



PROPOSED INTERIOR RENOVATION WORKS AT LOT 7 AND 9, JALAN DAGANG SB 4/1, TAMAN SUNGAI BESI INDAH, SERI KEMBANGAN, SELANGOR FOR HUMANITARIAN CARE MALAYSIA (MYCARE)

# Lvl 2: CEO office



PROPOSED INTERIOR RENOVATION WORKS AT LOT 7 AND 9, JALAN DAGANG SB 4/1, TAMAN SUNGAI BESI INDAH, SERI KEMBANGAN, SELANGOR FOR HUMANITARIAN CARE MALAYSIA (MYCARE)



**FIRADAUS  
KHAZIS  
ARCHITECT**

## Lvl 2: Office Area



PROPOSED INTERIOR RENOVATION WORKS AT LOT 7 AND 9, JALAN DAGANG SB 4/1, TAMAN SUNGAI BESI INDAH, SERI KEMBANGAN, SELANGOR FOR HUMANITARIAN CARE MALAYSIA (MYCARE)

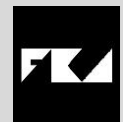

FIRADAUS  
KHAZIS  
ARCHITECT

Lvl 2: Pantry



PROPOSED INTERIOR RENOVATION WORKS AT LOT 7 AND 9, JALAN DAGANG SB 4/1, TAMAN SUNGAI BESI INDAH, SERI KEMBANGAN, SELANGOR FOR HUMANITARIAN CARE MALAYSIA (MYCARE)

## LVL 2: Pantry



PROPOSED INTERIOR RENOVATION WORKS AT LOT 7 AND 9, JALAN DAGANG SB 4/1, TAMAN SUNGAI BESI INDAH, SERI KEMBANGAN, SELANGOR FOR HUMANITARIAN CARE MALAYSIA (MYCARE)

*LVL 3: studio*



PROPOSED INTERIOR RENOVATION WORKS AT LOT 7 AND 9, JALAN DAGANG SB 4/1, TAMAN SUNGAI BESI INDAH, SERI KEMBANGAN, SELANGOR FOR HUMANITARIAN CARE MALAYSIA (MYCARE)



**FIRDAUS  
KHAZIS  
ARCHITECT**

*LVL 3: library/playarea*



PROPOSED INTERIOR RENOVATION WORKS AT LOT 7 AND 9, JALAN DAGANG SB 4/1, TAMAN SUNGAI BESI INDAH, SERI KEMBANGAN, SELANGOR FOR HUMANITARIAN CARE MALAYSIA (MYCARE)

LVL 3: lobi



PROPOSED INTERIOR RENOVATION WORKS AT LOT 7 AND 9, JALAN DAGANG SB 4/1, TAMAN SUNGAI BESI INDAH, SERI KEMBANGAN, SELANGOR FOR HUMANITARIAN CARE MALAYSIA (MYCARE)



FIRADAUS  
KHAZIS  
ARCHITECT

*LVL 3: studio*



PROPOSED INTERIOR RENOVATION WORKS AT LOT 7 AND 9, JALAN DAGANG SB 4/1, TAMAN SUNGAI BESI INDAH, SERI KEMBANGAN, SELANGOR FOR HUMANITARIAN CARE MALAYSIA (MYCARE)

# FACADE



PROPOSED INTERIOR RENOVATION WORKS AT LOT 7 AND 9, JALAN DAGANG SB 4/1, TAMAN SUNGAI BESI INDAH, SERI KEMBANGAN, SELANGOR FOR HUMANITARIAN CARE MALAYSIA (MYCARE)



FIRADAUS  
KHAZIS  
ARCHITECT

# FACADE



PROPOSED INTERIOR RENOVATION WORKS AT LOT 7 AND 9, JALAN DAGANG SB 4/1, TAMAN SUNGAI BESI INDAH, SERI KEMBANGAN, SELANGOR FOR HUMANITARIAN CARE MALAYSIA (MYCARE)

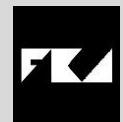

FIRADAUS  
KHAZIS  
ARCHITECT

# FACADE



PROPOSED INTERIOR RENOVATION WORKS AT LOT 7 AND 9, JALAN DAGANG SB 4/1, TAMAN SUNGAI BESI INDAH, SERI KEMBANGAN, SELANGOR FOR HUMANITARIAN CARE MALAYSIA (MYCARE)



FIRADAUS  
KHAZIS  
ARCHITECT

# FACADE



PROPOSED INTERIOR RENOVATION WORKS AT LOT 7 AND 9, JALAN DAGANG SB 4/1, TAMAN SUNGAI BESI INDAH, SERI KEMBANGAN, SELANGOR FOR HUMANITARIAN CARE MALAYSIA (MYCARE)



FIRADAUS  
KHAZIS  
ARCHITECT